



**Invitation to Bid
 On Timber Owned By
 William Church
 Wilkes County, NC**

**53.3 +/-Acres
 Sale Date – 11 AM – Thursday, March 6th, 2025**

Sawtimber	
Blackgum	2.5
Chestnut Oak	42.7
Hickory	8.5
Northern Red Oak	7.5
Red Maple	35.5
Scarlet Oak	23.9
Shortleaf Pine	3.6
Southern Red Oak	9.7
Sycamore	2.7
Virginia Pine	6.2
White Oak	104.6
White Pine	292.3
Yellow Poplar	180.8
Sawtimber Totals (Mbf)	720.5
Pulpwood	
Pine Pulpwood	161
Hard Hardwood Pulp	222
Soft Hardwood Pulp	512
Pulpwood Totals (tons)	895

LOCATION and ACCESS: The tract is located in Wilkes County, NC. From the intersection of US 421 and NC Hwy 115 go south on NC Hwy 115 for 2.8 miles. Turn left onto Fishing Creek Road and go 0.3 miles and timber will be on both sides of the road. A Casey & Company Timber Sale sign will be on your left. Gates have combination locks 4321. Please keep gates closed.

TIMBER SHOWING and SALE QUESTIONS: You are invited to look at the timber in the sale area at your convenience. Please call Andrew Casey at 336-984-6052 if you want a personal showing.

TIMBER INVENTORY: The volumes for the Sale area are based on a variable plot prism cruise. Acreage estimates are based on data taken with a resource grade GPS unit. Sawtimber was tallied to a 10 inch or merchantable top. Pulpwood was tallied to a 4 inch or merchantable top. Deductions for visible defects were made in the field. All sawtimber volumes are expressed in International ¼ inch

Log Rule, form class 78. Pulpwood volumes are expressed in tons and include topwood estimates. These volumes are an estimate and cannot be guaranteed.

SALE INFORMATION: Bids for the timber will be received as one lump sum. The timber and pulpwood in the Sale Area are being sold on a clearcut basis. Except for the creek buffers which are marked with blue flagging and paint. Only the trees marked with red paint may be cut in the creek buffers. Trees marked with blue paint in the sale area are not included in the sale. Sale boundaries are marked with orange paint and flagging. Loading will be allowed in the fields with permission of the Forester. Access is off of Spring Drive and Fishing Creek Road. Bids will be accepted by phone at 336-838-5766; by fax at 336-838-4465; by email acasey@caseyandcompany.com, or by personal delivery to the office of Casey & Company Forestry, PLLC until 11AM on Thursday, March 6th, 2025. All faxes and emails will be confirmed by telephone prior to the bid opening. The owner reserves the right to reject any and all bids. The successful bidder will be notified within 24 hours of the bid opening. The successful bidder may be required to make a 10 percent deposit within 24 hours of notification. The balance will be paid in full within 30 days from the date of acceptance. The sellers will be responsible for timber deed preparation. The buyer will be responsible for all other closing costs. A \$2,000 performance deposit will be payable at closing and held in a non-interest bearing trust account until satisfactory completion of logging. The performance deposit does not limit the buyer's liability.

CONDITIONS OF THE SALE:

1. The Buyer will have 24 months, from the date of timber deed, to complete all timber-harvesting activities.
2. Casey & Company Forestry, PLLC will be notified at least 48 hours in advance of the initiation of logging activities, and 48 hours in advance of completion.
3. No trees, limbs, or other logging debris will be left in or across the sale boundaries. Debris will be removed immediately.
4. All requirements concerning stream obstructions as found in the NC General Statutes must be honored. The Buyer is also required to comply with the Best Management Practices as established by The State of North Carolina.
5. No boundary line trees or other trees not included in the sale will be cut. If any are cut, they will be paid for at the rate of \$600/MBF International ¼ log rule. The sale boundaries are marked with orange paint and flagging.
6. The Buyer agrees to indemnify and save harmless the Seller and his agents against all claims, but not limited to, those which may arise in connection with the Buyer's operations on the described tract, including fines resulting from poor logging practices or Workers Compensation Claims. Buyer guarantees their loggers will be covered by Workers Compensation and General Liability Insurance in the amount of 1 million dollars and will provide satisfactory evidence of coverage at closing and maintain same throughout all logging operations.
7. Trash will be kept picked up at all times. All trash will be removed from the property, not buried.
8. This contract may not be sold or assigned without written permission of the Seller, except for financing purposes.
9. Casey & Company Forestry retains the right to suspend the logging operation in the event of excessive wet weather or due to poor performance from the logger. Extensions may be granted for weather related suspensions.
10. The logger must complete a pre-harvest and post-harvest inspection with Casey & Company Forestry, PLLC.
11. Any trees, limbs, or debris that is felled in the fields/open area must be removed and cleared immediately.
12. Grass will be established in disturbed pasture areas used for logging

Church Tract Volume Report¹ Wilkes County, NC

Stand Type	Mixed Hardwood	White Pine	Totals	Ave volume per tree (BDF)	Percent of Board Feet by Grade		
Stand Acres	36.7	16.6	53.3				
Avg. Volume per Acre (Mbf)	11.2	18.6	13.5				
Species	Sawtimber ² (Mbf)				Grade 1	Grades 2 & 3	Grade 4
Blackgum	2.5		2.5	138			
Chestnut Oak	34.0	8.7	42.7	178	12%	71%	17%
Hickory	8.5		8.5	129			
Northern Red Oak	1.9	5.6	7.5	238	75%	0%	25%
Red Maple	35.5		35.5	187	0%	70%	30%
Scarlet Oak	19.7	4.2	23.9	263	44%	38%	18%
Shortleaf Pine	3.6		3.6	261			
Southern Red Oak	9.7		9.7	924	0%	58%	42%
Sycamore	2.7		2.7	443			
Virginia Pine		6.2	6.2	103			
White Oak	72.3	32.3	104.6	202	33%	42%	25%
White Pine	97.1	195.2	292.3	336			
Yellow Poplar	123.5	57.3	180.8	171	22%	66%	12%
Sawtimber Totals (Mbf)	411.0	309.5	720.5				
Product	Pulpwood ³ (Tons)						
Pine Pulpwood	42	119	161				
Hard Hardwood Pulp	208	14	222				
Soft Hardwood Pulp	407	105	512				
Pulpwood Totals (Tons)	657	238	895				
1 The volumes are an estimate and cannot be guaranteed.							
2 The sawtimber volumes are reported in units of thousand board feet and were calculated using International 1/4 inch Log Rule, Form Class 78. 51 plots were taken as part of this inventory.							
3 The pulpwood volumes are reported in tons.							

William Church
 HWY 115

Tract: Volume, Total
 By Volume 1 Units and Species
 DBH classes by 2: 10-28+

Area (acres): 53.3

Diameter Breast Height (inches)

Species--Volume Table

	10	12	14	16	18	20	22	24	26	28+	Subtotal	
						MBF						
Blackgum--Inter 78	0.0	0.0	2.5	0.0	0.0	0.0	0.0	0.0	0.0	0.0	2.5	
Chestnut Oak--Inter 78	0.0	4.6	13.6	2.0	5.6	2.1	4.8	7.6	2.3	0.0	42.6	
Hickory--Inter 78	0.0	1.4	0.0	7.1	0.0	0.0	0.0	0.0	0.0	0.0	8.5	
Northern Red Oak--Inter 78	0.0	1.9	0.0	0.0	0.0	0.0	0.0	0.0	5.6	0.0	7.5	
Red Maple--Inter 78	5.4	4.1	5.8	6.0	0.0	0.0	4.8	9.4	0.0	0.0	35.5	
Scarlet Oak--Inter 78	0.0	0.0	0.0	7.3	0.0	0.0	10.1	3.2	3.3	0.0	23.9	
Shortleaf Pine--Inter 78	0.0	0.0	0.0	3.6	0.0	0.0	0.0	0.0	0.0	0.0	3.6	
Southern Red Oak--Inter 78	2.1	0.0	0.0	0.0	0.0	0.0	0.0	0.0	7.6	0.0	9.7	
Sycamore--Inter 78	0.0	0.0	0.0	0.0	0.0	0.0	0.0	2.7	0.0	0.0	2.7	
Virginia Pine--Inter 78	6.2	0.0	0.0	0.0	0.0	0.0	0.0	0.0	0.0	0.0	6.2	
White Oak--Inter 78	0.0	2.8	3.9	45.0	30.4	10.3	12.1	0.0	0.0	0.0	104.6	
White Pine--Inter 78	3.3	14.9	4.5	20.2	46.6	53.6	55.5	39.0	33.1	21.6	292.3	
Yellow-Poplar--Inter 78	17.8	10.5	40.0	69.0	26.5	0.0	17.0	0.0	0.0	0.0	180.9	
Total	34.8	40.3	70.2	160.2	109.1	66.0	104.4	62.0	51.9	21.6	720.6	

William Church
Wilkes County, NC
Scale 1 Inch = 400 Feet
Contour Interval = 20 Feet



Casey & Co Sign

Legend

Roads

- Logging Access
- === Spring Drive
- 🌿 Gate
- ⋯ Creeks
- ▭ Hardwood
- ▭ White Pine

**William Church
Wilkes County, NC**

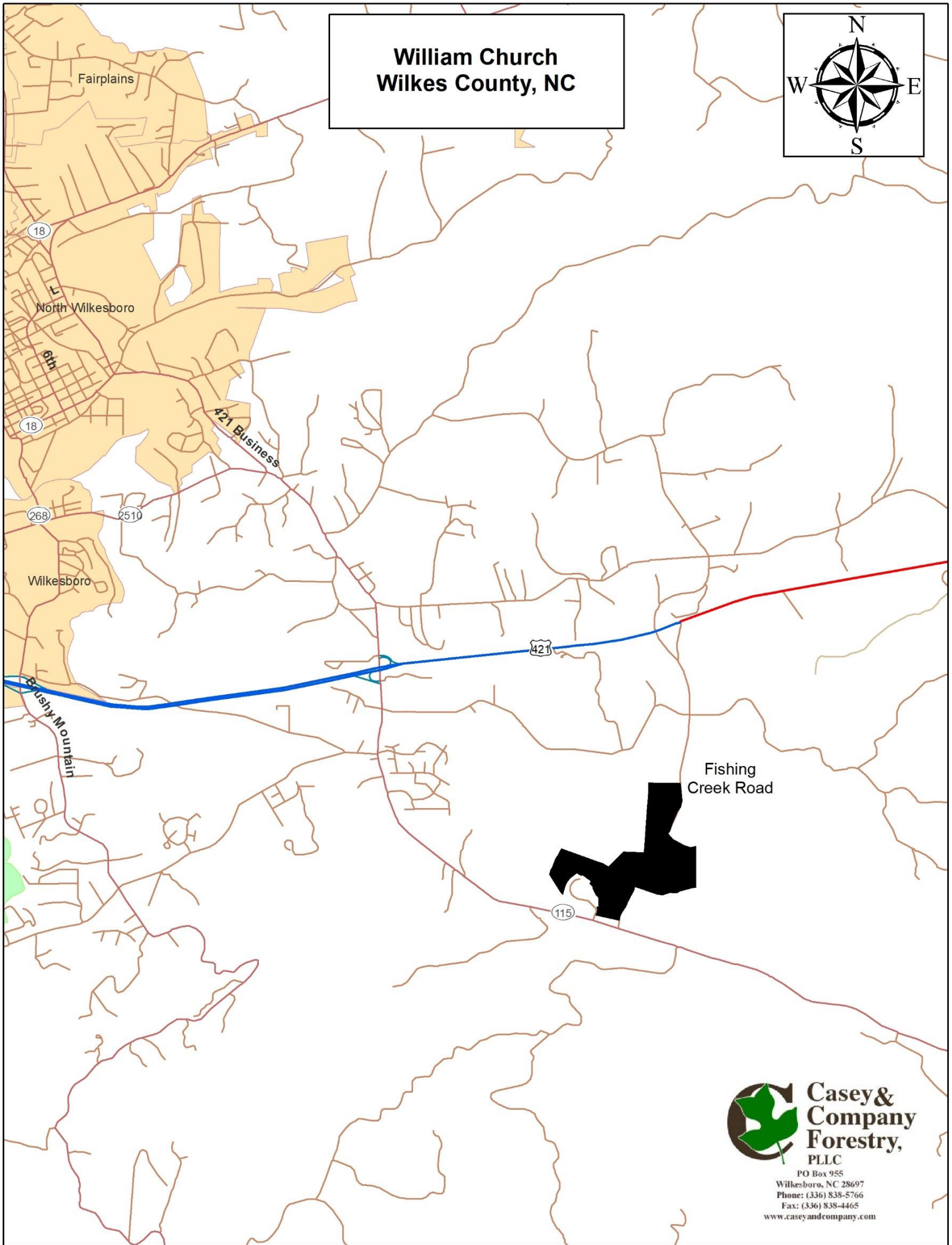
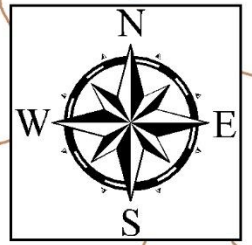

**Casey &
Company
Forestry,
PLLC**

PO Box 955
Wilkesboro, NC 28697
Phone: (336) 838-5766
Fax: (336) 838-4465
www.caseyandcompany.com